

Led round ceiling lamplight 50/100%

CODE: HALF MOON

LED round ceiling lamps with CCT technology.

Equipped with double inputs to select full light or 50% light, which can be installed on the ceiling or wall.

Round ceiling lamps with integrated plate with high luminous LEDs for a uniform diffusion of light on the entire surface.

White techno-polymer body with high mechanical resistance.

High diffusion satin diffuser in polycarbonato.

Equipped with rear bracket for wall mounting.

Complete with terminals for electrical connections.

IP44 CRI 80

Features

- Power supply: 230V ~ 50Hz
- Colour rendering: >80
- Light efficiency: 90 lm/W
- Power factor: >0.7
- Average life: 30.000 hours
- Operating temperature: -20°C +40°C
- Insulation class: II
- Beam angle: 120°
- Protection degree: IP44, for outdoor use
- Shockproof: IK10

Technical data

Article	Dimensions	Total consumption	Color	Luminous flux	Angle of diffusion	Weight
HMN15.WW	Ø280x62 mm	20 W	3.000°K - 4.000°K	1.650 lm	120°	660 gr
HMN20.WW	Ø330x68 mm	24 W	3.000°K - 4.000°K	2.250 lm	120°	810 gr

Data sheets

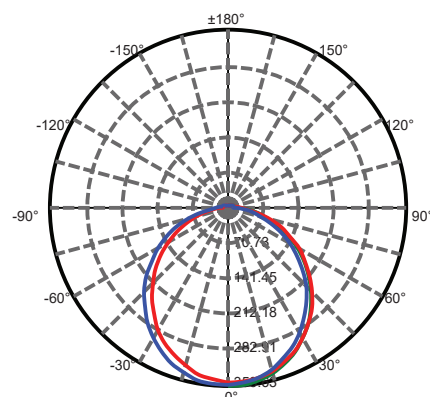
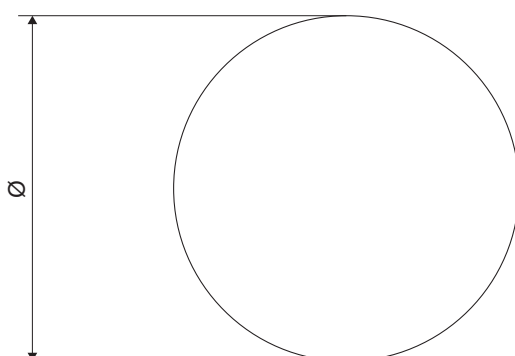
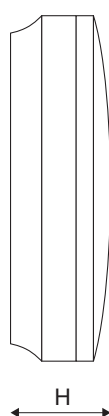

Cabinets and recessed

